

PRZEKRÓJ:1: OŚ_0
SKALA 1:1000/100

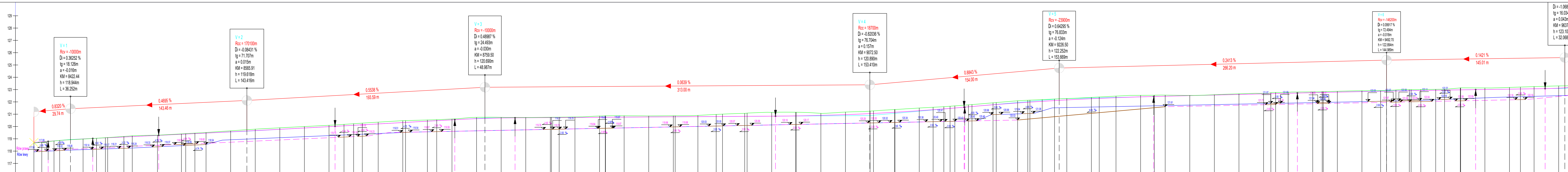

NUMER PRZEKROJU	KILOMETRAŻ	RZĘDNE NIWELETY	RZĘDNA TERENU	RÓŻNICA RZĘDNYCH	PRZECHYLENIA	PRZECHYLENIA	ELEMENTY POZIOME	SZEROKOŚĆ JEZDNI	KILOM. I HEKTOM.
P1	8+400	118.70	118.65	0.04	2.00%	2.00%	Szczyt I=10.49	3.00	8+400
Z_1	8+410	118.75	118.72	0.03	2.00%	2.00%		3.00	
Z_2	8+420	118.79	118.75	0.02	2.00%	2.00%		3.00	
Z_3	8+430	118.83	118.81	0.01	2.00%	2.00%		3.00	
P2	8+440	118.87	118.87	0.00	2.00%	2.00%		3.00	
Z_4	8+450	118.91	118.91	0.00	2.00%	2.00%		3.00	
Z_5	8+460	118.94	118.94	0.00	2.00%	2.00%		3.00	
Z_6	8+470	118.97	118.97	0.00	2.00%	2.00%		3.00	
Z_7	8+480	119.00	119.00	0.00	2.00%	2.00%		3.00	
P3	8+490	119.03	119.03	0.00	2.00%	2.00%		3.00	
Z_8	8+500	119.06	119.06	0.00	2.00%	2.00%		3.00	
Z_9	8+510	119.09	119.09	0.00	2.00%	2.00%		3.00	
P4	8+520	119.12	119.12	0.00	2.00%	2.00%		3.00	
Z_10	8+530	119.15	119.15	0.00	2.00%	2.00%		3.00	
Z_11	8+540	119.18	119.18	0.00	2.00%	2.00%		3.00	
P5	8+550	119.21	119.21	0.00	2.00%	2.00%		3.00	
Z_12	8+560	119.24	119.24	0.00	2.00%	2.00%		3.00	
Z_13	8+570	119.27	119.27	0.00	2.00%	2.00%		3.00	
P6	8+580	119.30	119.30	0.00	2.00%	2.00%		3.00	
Z_14	8+590	119.33	119.33	0.00	2.00%	2.00%		3.00	
Z_15	8+600	119.36	119.36	0.00	2.00%	2.00%		3.00	
P7	8+610	119.39	119.39	0.00	2.00%	2.00%		3.00	
Z_16	8+620	119.42	119.42	0.00	2.00%	2.00%		3.00	
Z_17	8+630	119.45	119.45	0.00	2.00%	2.00%		3.00	
P8	8+640	119.48	119.48	0.00	2.00%	2.00%		3.00	
Z_18	8+650	119.51	119.51	0.00	2.00%	2.00%		3.00	
Z_19	8+660	119.54	119.54	0.00	2.00%	2.00%		3.00	
P9	8+670	119.57	119.57	0.00	2.00%	2.00%		3.00	
Z_20	8+680	119.60	119.60	0.00	2.00%	2.00%		3.00	
Z_21	8+690	119.63	119.63	0.00	2.00%	2.00%		3.00	
P10	8+700	119.66	119.66	0.00	2.00%	2.00%		3.00	
Z_22	8+710	119.69	119.69	0.00	2.00%	2.00%		3.00	
Z_23	8+720	119.72	119.72	0.00	2.00%	2.00%		3.00	
P11	8+730	119.75	119.75	0.00	2.00%	2.00%		3.00	
Z_24	8+740	119.78	119.78	0.00	2.00%	2.00%		3.00	
Z_25	8+750	119.81	119.81	0.00	2.00%	2.00%		3.00	
P12	8+760	119.84	119.84	0.00	2.00%	2.00%		3.00	
Z_26	8+770	119.87	119.87	0.00	2.00%	2.00%		3.00	
Z_27	8+780	119.90	119.90	0.00	2.00%	2.00%		3.00	
P13	8+790	119.93	119.93	0.00	2.00%	2.00%		3.00	
Z_28	8+800	119.96	119.96	0.00	2.00%	2.00%		3.00	
Z_29	8+810	119.99	119.99	0.00	2.00%	2.00%		3.00	
P14	8+820	120.02	120.02	0.00	2.00%	2.00%		3.00	
Z_30	8+830	120.05	120.05	0.00	2.00%	2.00%		3.00	
Z_31	8+840	120.08	120.08	0.00	2.00%	2.00%		3.00	
P15	8+850	120.11	120.11	0.00	2.00%	2.00%		3.00	
Z_32	8+860	120.14	120.14	0.00	2.00%	2.00%		3.00	
Z_33	8+870	120.17	120.17	0.00	2.00%	2.00%		3.00	
P16	8+880	120.20	120.20	0.00	2.00%	2.00%		3.00	
Z_34	8+890	120.23	120.23	0.00	2.00%	2.00%		3.00	
Z_35	8+900	120.26	120.26	0.00	2.00%	2.00%		3.00	
P17	8+910	120.29	120.29	0.00	2.00%	2.00%		3.00	
Z_36	8+920	120.32	120.32	0.00	2.00%	2.00%		3.00	
Z_37	8+930	120.35	120.35	0.00	2.00%	2.00%		3.00	
P18	8+940	120.38	120.38	0.00	2.00%	2.00%		3.00	
Z_38	8+950	120.41	120.41	0.00	2.00%	2.00%		3.00	
Z_39	8+960	120.44	120.44	0.00	2.00%	2.00%		3.00	
P19	8+970	120.47	120.47	0.00	2.00%	2.00%		3.00	
Z_40	8+980	120.50	120.50	0.00	2.00%	2.00%		3.00	
Z_41	8+990	120.53	120.53	0.00	2.00%	2.00%		3.00	
P20	8+1000	120.56	120.56	0.00	2.00%	2.00%		3.00	
Z_42	8+1010	120.59	120.59	0.00	2.00%	2.00%		3.00	
Z_43	8+1020	120.62	120.62	0.00	2.00%	2.00%		3.00	
P21	8+1030	120.65	120.65	0.00	2.00%	2.00%		3.00	
Z_44	8+1040	120.68	120.68	0.00	2.00%	2.00%		3.00	
Z_45	8+1050	120.71	120.71	0.00	2.00%	2.00%		3.00	
P22	8+1060	120.74	120.74	0.00	2.00%	2.00%		3.00	
Z_46	8+1070	120.77	120.77	0.00	2.00%	2.00%		3.00	
Z_47	8+1080	120.80	120.80	0.00	2.00%	2.00%		3.00	
P23	8+1090	120.83	120.83	0.00	2.00%	2.00%		3.00	
Z_48	8+1100	120.86	120.86	0.00	2.00%	2.00%		3.00	
Z_49	8+1110	120.89	120.89	0.00	2.00%	2.00%		3.00	
P24	8+1120	120.92	120.92	0.00	2.00%	2.00%		3.00	
Z_50	8+1130	120.95	120.95	0.00	2.00%	2.00%		3.00	
Z_51	8+1140	120.98	120.98	0.00	2.00%	2.00%		3.00	
P25	8+1150	121.01	121.01	0.00	2.00%	2.00%		3.00	
Z_52	8+1160	121.04	121.04	0.00	2.00%	2.00%		3.00	
Z_53	8+1170	121.07	121.07	0.00	2.00%	2.00%		3.00	
P26	8+1180	121.10	121.10	0.00	2.00%	2.00%		3.00	
Z_54	8+1190	121.13	121.13	0.00	2.00%	2.00%		3.00	
Z_55	8+1200	121.16	121.16	0.00	2.00%	2.00%		3.00	
P27	8+1210	121.19	121.19	0.00	2.00%	2.00%		3.00	
Z_56	8+1220	121.22	121.22	0.00	2.00%	2.00%		3.00	
Z_57	8+1230	121.25	121.25	0.00	2.00%	2.00%		3.00	
P28	8+1240	121.28	121.28	0.00	2.00%	2.00%		3.00	
Z_58	8+1250	121.31	121.31	0.00	2.00%	2.00%		3.00	
Z_59	8+1260	121.34	121.34	0.00	2.00%	2.00%		3.00	
P29	8+1270	121.37	121.37	0.00	2.00%	2.00%		3.00	
Z_60	8+1280	121.40	121.40	0.00	2.00%	2.00%		3.00	
Z_61	8+1290	121.43	121.43	0.00	2.00%	2.00%		3.00	
P30	8+1300	121.46	121.46	0.00	2.00%	2.00%		3.00	
Z_62	8+1310	121.49	121.49	0.00	2.00%	2.00%		3.00	
Z_63	8+1320	121.52	121.52	0.00	2.00%	2.00%		3.00	
P31	8+1330	121.55	121.55	0.00	2.00%	2.00%		3.00	
Z_64	8+1340	121.58	121.58	0.00	2.00%	2.00%		3.00	
Z_65	8+1350	121.61	121.61	0.00	2.00%	2.00%		3.00	
P32	8+1360	121.64	121.64	0.00	2.00%	2.00%		3.00	
Z_66	8+1370	121.67	121.67	0.00	2.00%	2.00%		3.00	
Z_67	8+1380	121.70	121.70	0.00	2.00%	2.00%		3.00	
P33	8+1390	121.73	121.73	0.00	2.00%	2.00%		3.00	
Z_68	8+1400	121.76	121.76	0.00	2.00%	2.00%		3.00	
Z_69	8+1410	121.79	121.79	0.00	2.00%	2.00%		3.00	
P34	8+1420	121.82	121.82	0.00	2.00%	2.00%		3.00	
Z_70	8+1430	121.85	121.85	0.00	2.00%	2.00%		3.00	
Z_71	8+1440	121.88	121.88	0.00	2.00%	2.00%		3.00	
P35	8+1450	121.91	121.91	0.00	2.00%	2.00%		3.00	
Z_72	8+1460	121.94	121.94	0.00	2.00%	2.00%		3.00	
Z_73	8+1470	121.97	121.97	0.00	2.00%	2.00%		3.00	
P36	8+1480	122.00	122.00	0.00	2.00%	2.00%		3.00	
Z_74	8+1490	122.03	122.03	0.00	2.00%	2.00%		3.00	
Z_75	8+1500	122.06	122.06	0.00	2.00%	2.00%		3.00	
P37	8+1510	122.09	122.09	0.00	2.00%	2.00%		3.00	
Z_76	8+1520	122.12	122.12	0.00	2.00%	2.00%		3.00	
Z_77	8+1530	122.15	122.15	0.00	2.00%	2.00%		3.00	
P38	8+1540	122.18	122.18	0.00	2.00%	2.00%		3.00	
Z_78	8+1550	122.21	122.21	0.00	2.00%	2.00%		3.00	
Z_79	8+1560	122.24	122.24	0.00	2.00%	2.00%		3.00	
P39	8+1570	122.27	122.27	0.00	2.00%	2.00%		3.00	
Z_80									